



INTELLIO VISUS BOX

ILD-810B

MAIN FEATURES

- On-board VCA
- 14 megapixel sensor
- Effective resolution: 4096x3072
- H.264 - Hierarchical P encoding
- Camera-side bandwidth management

OPTIONAL ACCESSORIES AND LENSES

Power supplies	ILA-PS-12-H-EU	
LENSES		
Lens type	Horizontal view angle range	Vertical view angle range
M125VD4510-IR	73-33°	55-25°
DV4x12.5SR-4ASA1L	26-7°	20-5°
SL940A	36-8°	27-6°

CAMERA

Image Sensor	Aptina 14MP 1/2.3" CMOS Progressive Scan
Sensitivity	Day/Night: 0.65 lux / 0.01 lux
Shutter time	1/6s - 1/20,000s
Day/night mode	True
WDR mode	Software
Lenses	1/2.5" format, C/CS mount, DC iris, megapixel resolution

COMPRESSION

Video Compression	H.264 - Hierarchical P encoding
Bit Rate	500Kbps - 18Mbps
Streaming	Intellio Video Streaming, Dual streaming over RTSP
NETWORK	
Protocols	NTP, TCP/IPv4, DHCP, DNS
Security	Camera User Name and Password

IMAGE

Resolution	4:3: 4096x3072, 3840x2880, 3200x2400, 3072x2304, 2560x1920, 1920x1440, 1280x960, 640x480 16:9: 4096x2304, 3840x2160, 3200x1800, 3072x1728, 2560x1440, 1920x1080, 1280x720, 640x360
Frame Rate	H.264 4:3: 8fps (4096x3072), 14fps (2560x1920), 22fps (1920x1440), 40fps (1280x960) H.264 16:9: 10fps (4096x2304), 16fps (2560x1440), 30fps (1920x1080), 45fps (1280x720)
Image Settings	Brightness, Contrast, Gamma, Saturation, Sharpness, Noise Filtering, White balance (5 presets), Operation mode (gain/exp preference), Exposure control, Gain control, Anti-flickering (50Hz/60Hz), Backlight compensation (adjustable zones), Software WDR mode, Day/Night mode (Auto/Day/Night), Day/Night mode preference, Image Mirroring
Encoder Settings	Codec Type, Quality, I-frame Distance, Resolution, Frame Limit, Reduced Frame Rate Control, Bandwidth Limit, Pre- and Post-alarm

INTERFACE

Ethernet	10BaseT/100BaseTX, RJ-45
IO Ports	6 Pin IO Connector (1 Output (2 Pins), 1 Input (2 Pins), GND, AUX Voltage)
Reset Button	Reset To Factory Defaults (IP Address Reset)
SD-card slot	Yes

CAMERA SOFTWARE

Motion Detection	64 polygon per mask, 8 masks, All masks with adjustable sensitivity and motion percent parameters, Separated motion detector for monitoring and for recording
------------------	---

GENERAL

Operating Conditions	0 °C - 45 °C
Power Connector	Screw Fixable Terminal Blocks Accessory: Power connector (DC jack 5.5mm/2.1mm)
Power Supply	12V DC (+2V, -3V), 650mA / PoE Support (IEEE 802.3af - PoE Class 3)
Power Consumption	Max. 7.5W
Weight	385g (without lens)
Certificates	CE: EN 55022, EN 55024, RoHS compliant, FCC compliant in progress

INTELLIGENT VIDEO

Detectors	Motion Detector Tampering detectors: Covering detection, Rotation detection IO port input detector
Extended Intelligence	Tracker based detectors: Intelligent motion detection, Tripwire detection, Entry detection, Direction detection Object based detector: Object removal / theft detection
Object Tracker	64 polygon for masking, Object behavior settings, Day-time/Night-time sensitivity, Environmental settings

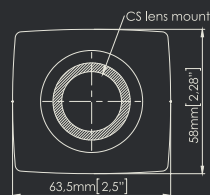
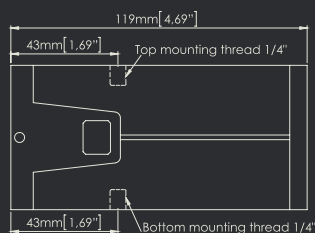

4K
RESOLUTION



FULL HD
RESOLUTION
SUPPORT



H.264
HIERARCHICAL P



POE
SUPPORT



ON-BOARD
STORAGE ON
USB DRIVE



ON-BOARD
STORAGE ON
SD CARD



ON-BOARD
PLAYBACK



ITRACKING
TECHNOLOGY



ISHOT
TECHNOLOGY